

In this Issue:

New LANCER LEV Portion Control replaces the TouchSensor Portion Control2
New LANCER EZ-Fill Valve Update3

Technical Bulletin Distribution:

The Lancer Engineering Department publishes a Technical Bulletin every other month. To subscribe or unsubscribe from the Tech Bulletin, go to lancerworldwide.com. Lancer Installation and Service Manuals, Instruction Sheets, previous Technical Bulletins, and a complete index of Technical Bulletin articles are also available at lancerworldwide.com. For general questions about the Tech Bulletin, email custserv@lancerworldwide or call (888) 846-6729.

Contact Information:

Lancer Sales: (800) 729-1500
Lancer Customer Service: (800) 729-1500
Lancer Warranty: (800) 729-1550
Lancer USA: (210) 310-7000
Canada: (210) 310-7187
Latin America: (210) 310-7000
International Sales: (210) 310-7063
Europe: 32-2-755-2390
Australia/New Zealand: 61-8-8268-1388
Email: custserv@lancerworldwide.com
Lancer Website: www.lancerworldwide.com



There is a new LEV Touch Portion Control ID Panel that replaces the TouchSensor EasyTouch Portion Control ID Panels.

The enhanced capacitive touch buttons have a clean look and are more attractive than the EasyTouch portion control ID Panel.

Programming is the same and is included in the LEV installation manual and the instruction sheet supplied with the kits.



LANCER
CCP# 104561

LEV Touch Portion Control Kit

Coca-Cola Parts: CCP# 104561

Lancer: 82-7414



TouchSensor
CCP# 104561

Issue:

Lancer EZ-Fill valves were having issues with continuity causing the valves to remain in the on position and not shut off once activated.

Cause:

Originally, a supplier discontinued the production of the conductive plastic resin that the bonnet was made of. We used that conductive resin to provide continuity throughout the flow stream, allowing there to be a complete circuit and triggering shut off when water touched the lever and the valve.

Once that plastic resin was discontinued, Lancer decided to move to a modified harness that will allow the ground to be placed on the facet plate and connect to the flow stream from the back block. This solution later caused issues where sometimes the circuit board would short out. Other times there were issues with having a proper ground and the valves would not shut off.

Correction:

Lancer has decided to move back to using the bonnet, but instead of sourcing a conductive plastic resin, Lancer decided to use a stainless-steel bonnet. This will provide necessary continuity, remove the risk of shorting the circuit board, and allow for a consistent ground source.

Previous EZ-Fill

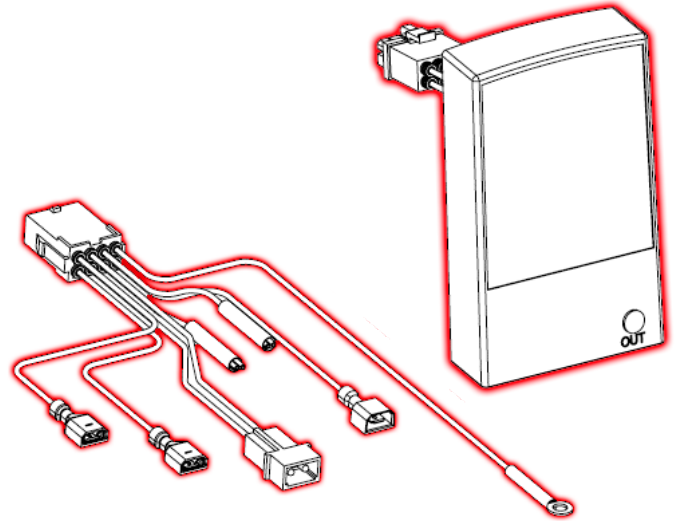

New EZ-Fill

Harness: 52-4130

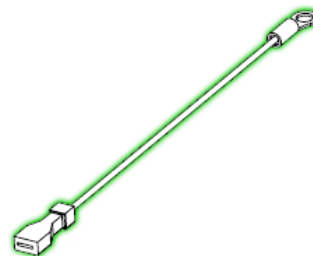

ID Panel: 52-3311

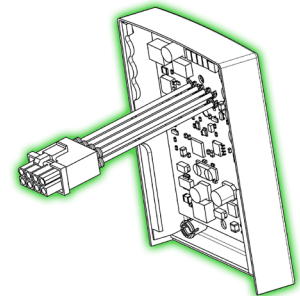

Bonnet: 10-2061

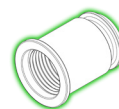

Retainer: 30-7842

