

In This Issue:

FS30 Pellet Ice Conversion Update.....2-3

Improved Water Button Kit 82-5262/01.....4

Technical Bulletin Distribution:

The Lancer Engineering Department publishes a Technical Bulletin every other month. To subscribe or unsubscribe from the Tech Bulletin, go to lancercorp.com. Click on the Contact link and scroll down to Technical Publications. Lancer Installation and Service Manuals, Instruction Sheets, previous Technical Bulletins, and a complete index of Technical Bulletin articles are also available at lancercorp.com. For general questions about the Tech Bulletin, email techpubs@lancercorp.com or call (210) 310-7230.

Contact Information

- Lancer Sales: (800) 729-1500
- Lancer Customer Service: (800) 729-1500
- Lancer Warranty: (800) 729-1550
- Lancer USA: (210) 310-7000
- Canada: (210) 310-7187
- Latin America: (210) 310-7000
- International Sales: (210) 310-7063
- Europe: 32-2-755-2390
- Australia/New Zealand: 61-8-8268-1388
- Email: custserv@lancercorp.com
- Lancer Website: www.lancercorp.com



One of the benefits of using a Lancer Flavor Select Dispenser is the ability to change the dispensable ice type in the field from cubed ice to pellet ice. The FS30 Pellet Ice Conversion kit (Lancer Part Number: 82-3633) provides the ability, for a qualified installer, to change the existing cubed ice components to pellet ice components. Once the installation of the pellet ice components is complete, the unit's ice type settings on the unit's control board must be changed from cubed to pellet ice as well, otherwise the agitation timing will be off and the ice stored in the unit could clump together, or otherwise cause issues.

If a converted FS30 unit is dispensing pellet ice and its ice type setting is set to "Cubed", it is very simple to change the setting to "Pellet":

1. First turn off the ice maker and melt all the existing ice in the ice bin.
2. Access the FS Control Board by removing the merchandiser.
3. Use the arrows on the control board to navigate to the "CONFIG ICE TYPE" menu and press Enter.
4. Use the right arrow to change the ice type setting from "CUBE" to "PELLET" and press Enter.

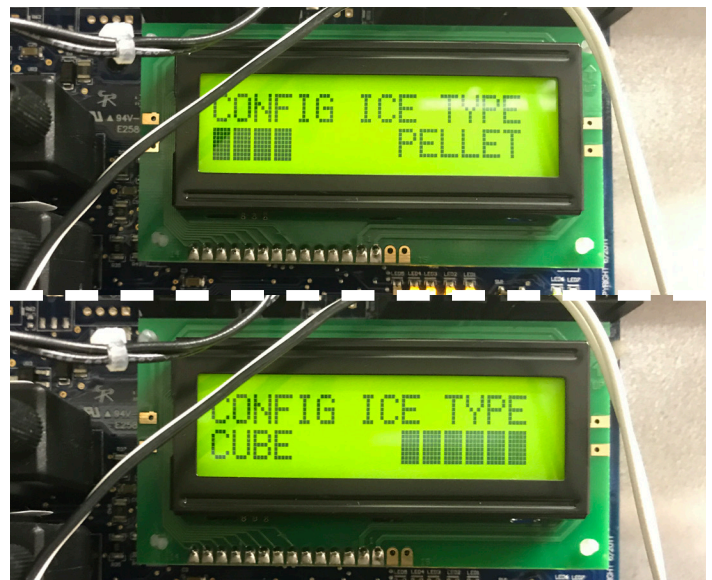

5. Use the arrows to navigate to the “VW ICE STIR TMS” menu and press Enter.
6. Verify that the Ice Stir On setting is “4000” and the Ice Stir Off setting is “150”.



For older units with the older software and control board installed, you must change the agitation times manually:

1. Use the arrows on the control board to navigate to the “FS16 SETUP - ICE STIR OFF” menu and press Enter.
2. Use the left/right arrows to highlight which digit to change and the up/down arrows to change the highlighted digit. Change the “OFF TIME (MIN)” setting to read “150”. Press the Enter key when complete.
3. Use the arrows to navigate to the “FS16 SETUP - ICE STIR ON” menu and press Enter.
4. Use the left/right arrows to highlight which digit to change and the up/down arrows to change the highlighted digit. Change the “ON TIME (MSEC)” setting to read “4000”. Press the Enter key when complete.



For more information on converting an existing unit from cubed to pellet ice or any other of our many field conversion kits, visit lancercorp.com or call your Lancer Customer Service representative at (800) 729-1500 or email custserv@lancercorp.com.

LANCER®

Lancer has made improvements to the Water Button Kit, PN: 82-5262/01 in order to be compatible with any and all of the Lancer product lines.



Standard Installation



**Wedge Space Installation
Lowers Button 0.5"**



Sensation 44 Installation

The new Water Button Kit is compatible with both the LEV and VersaPour valves and now contains a wedge spacer and longer screw to lower the button which allows for installation on full merchandiser units, such as on the Sensation 44 and Blue Star units.

The wedge spacer also lowers the button height on IBD installations to reach ADA requirements. The new blue water button design also improves visibility for the customer when trying to pour water or soda from the valve.

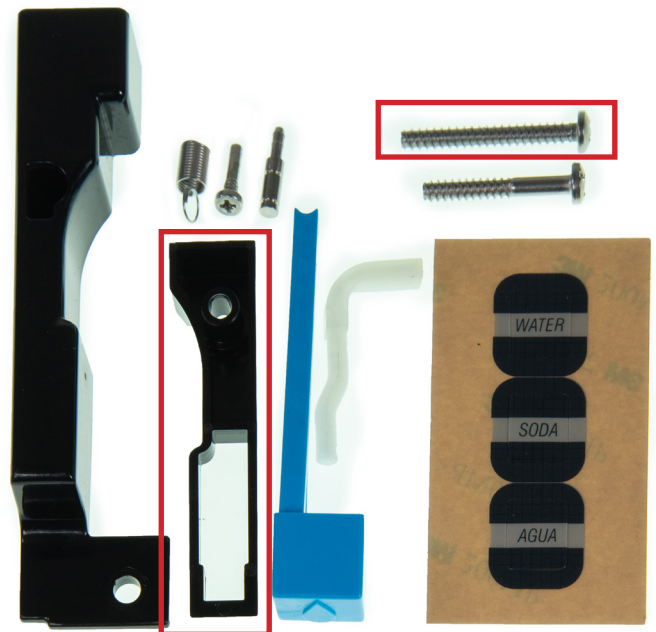

The addition of the Wedge Spacer and a longer screw provides more mounting options