

IN THIS ISSUE:

| | |
|---|---|
| New Front Soda/Water Push Button Kit..... | 2 |
| New Accessibility Display Panel for Coc-Cola Bridge Towers..... | 3 |

TECHNICAL BULLETIN DISTRIBUTION

The Lancer Engineering Department publishes a Technical Bulletin every month. To subscribe or unsubscribe from the Tech Bulletin, go to lancercorp.com. Click on the Contact link and scroll down to Technical Publications. Lancer Installation and Service Manuals, Instruction Sheets, previous Technical Bulletins, and a complete index of Technical Bulletin articles are also available at lancercorp.com. For general questions about the Tech Bulletin, email techpubs@lancercorp.com or call (210) 310-7230.

CONTACT INFO

Lancer Sales: (800) 729-1500
Lancer Customer Service: (800) 729-1500
Lancer Warranty: (800) 729-1550
Lancer USA: (210) 310-7000
Canada: (210) 310-7187
Latin America: (210) 310-7000
International Sales: (210) 310-7063
Europe: 32-2-755-2390
Australia/New Zealand: 61-8-8268-1388
Email: custserv@lancercorp.com
Lancer Website: www.lancercorp.com



New Front Soda/Water Push Button Kit

Technical Bulletin Reference No. 2402-001

Lancer is proud to introduce the new Front Soda/Water Button. The new push button design is easier service, has a more intuitive activation, and is more durable than the older lever-actuation design. The new Soda/Water Button kits will continue using the CCNA# 958609 where applicable and will be compatible across both the LEV and VersaPour valve models.

82-1458/02

KIT, FRT SODA LVR, VLV



82-5172

KIT, FRT SODA/WATER PUSH BUTTON, VLV



For more information on the new Front Soda/Water Button kits, contact Lancer Customer Service at (800) 729-1500.

New Accessibility Display Panel for Coca-Cola Bridge Towers

Technical Bulletin Reference No. 2402-002

In order to assure that beverage service on the Coca-Cola Bridge Tower is accessible to all customers, Lancer has introduced the new Accessibility Display Panel. The Accessibility Panel functions the same as the main unit screen and displays any current brand configuration on the main selection screen. The panel is installed remotely to counter and connects to any new or existing Bridge Towers currently in the field.

Lancer PN: 82-5055 - ADA ASSY, BRIDGE

Counter Cutout For ADA Panel

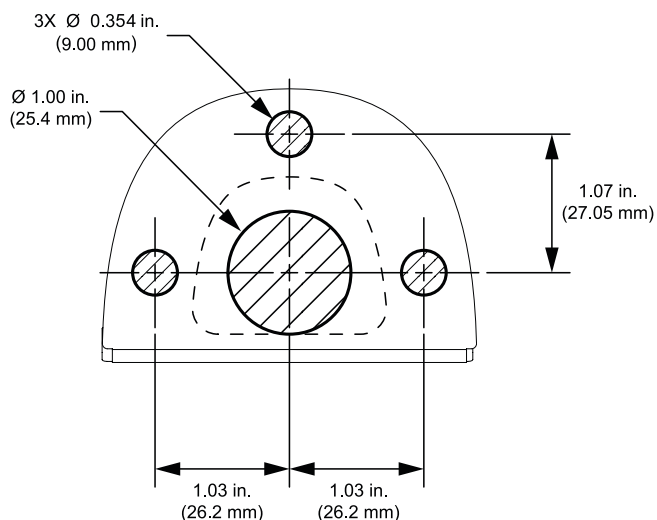

For more information on the new Bridge Tower Accessibility Display Panel kits, contact Lancer Customer Service at (800) 729-1500 or email us at custserv@lancercorp.com.

