

The following illustrates how to remove the existing valve syrup flow control and replace it with the new Brix Screw flow control.

Kit Contents - 82-6003

<u>Part Number</u>	<u>Description</u>
--------------------	--------------------

54-0548/01	Brix Screw, LEV
------------	-----------------

03-0529	Dual GMV Retainer, Brix Flow Control
---------	--------------------------------------

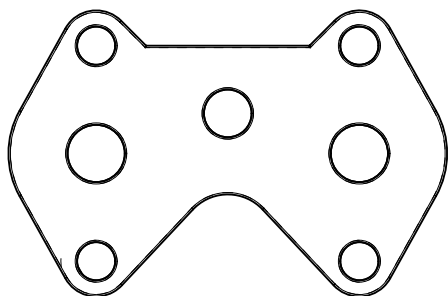

03-0529

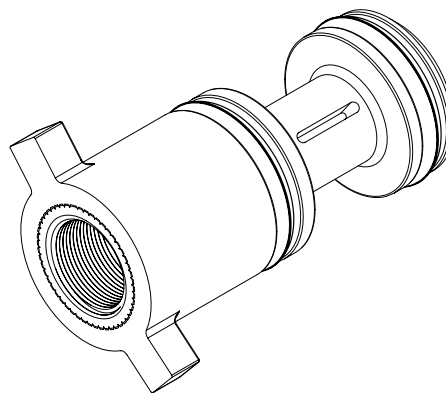

54-0548/01

Necessary Tools

- Flathead Screwdriver
- Flow Control Extractor Tool (Lancer PN: 52-1950)



52-1950

Installation

1. Unplug unit power cord from wall outlet.
2. Remove the unit merchandiser and splash plate, if necessary.
3. Slide up on ID Panel to remove from valve.
4. Loosen the retainer screw, in front of valve, to remove valve cover.

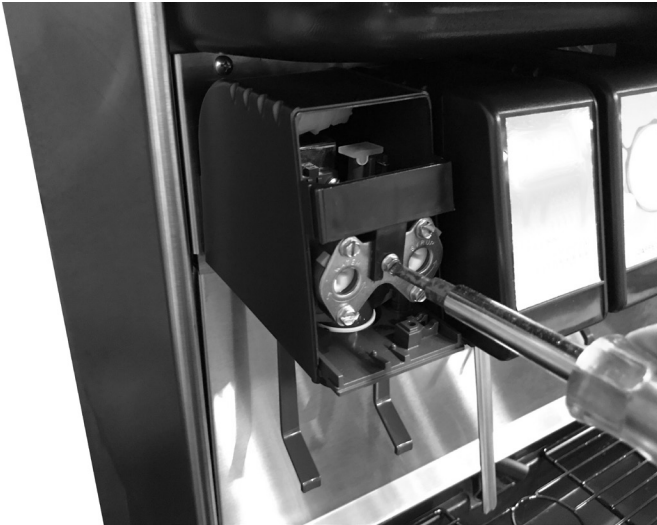

5. If attached to unit, disconnect valve wire harness, close the valve stems on the backblock.
6. Using a flathead screwdriver, remove the five retainer screws and remove the existing retainer from valve.



7. Using the extractor tool (Lancer PN: 52-1950), screw the tool into the syrup (right side) flow control then carefully pull out the flow control bonnet and spring.

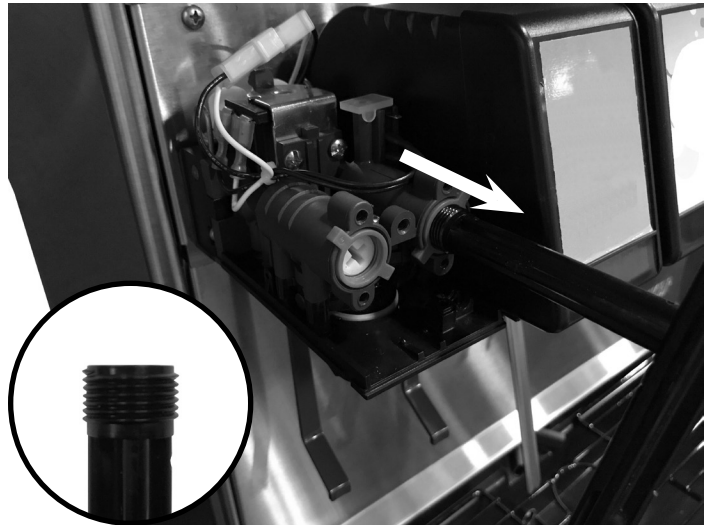

8. Insert the smaller, piston remover, end of the extractor tool into the flow control until the tool catches onto the piston. Once the tool catches, pull out the tool to remove the valve piston.

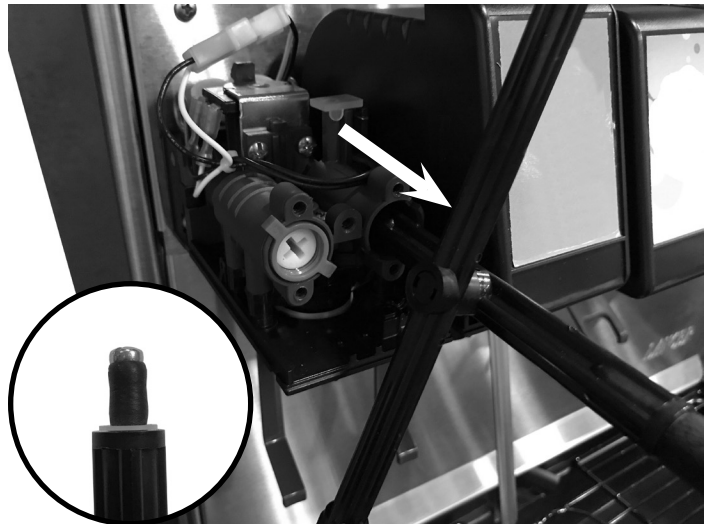

9. Insert the wider end of the extractor tool into the flow control until it catches on the piston sleeve. Once the tool catches, pull out the tool to remove the piston sleeve.

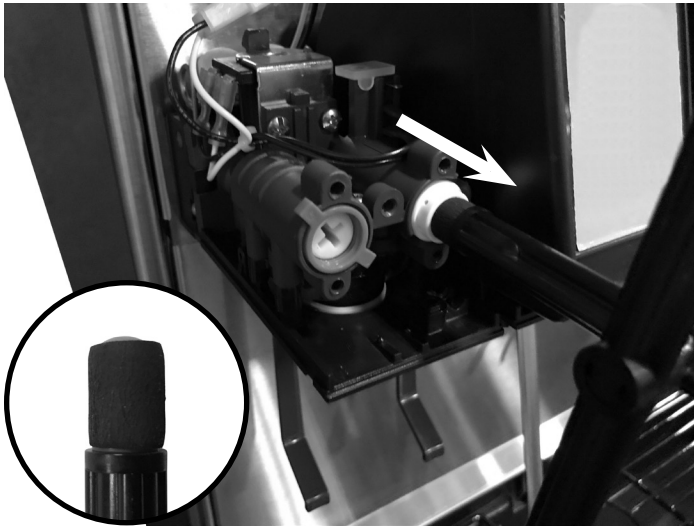

10. Once the existing sleeve, piston, and flow control bonnet are removed, insert the new brix screw (PN: 54-0548/01) included with kit into the flow control.

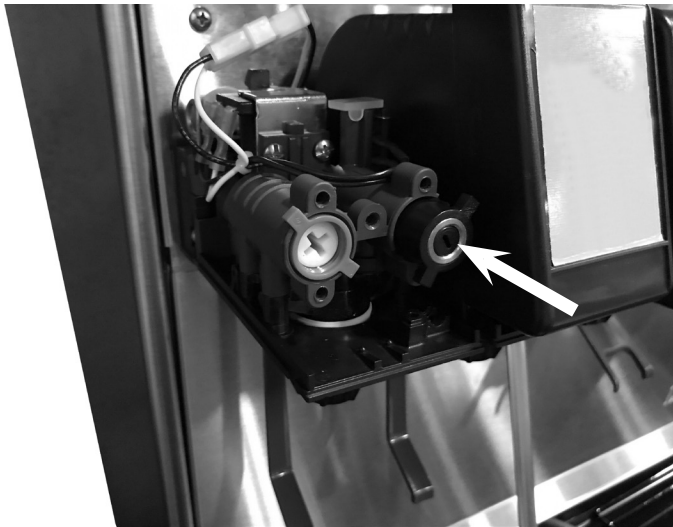

NOTE

In order to fully insert the new brix screw into the flow control, it may be necessary to release the trapped air in the flow control cavity. Activate the valve lever or remove valve from unit to release the trapped air in the valve flow control.

11. Using the five (5) screws removed in Step 5, install the new valve retainer (PN: 03-0529) included with kit to the valve.



12. Open the valve stems on the backblock and re-connect valve wire harness.
13. Plug in the dispenser into the grounded wall electrical outlet.
14. Using a flathead screwdriver, set the flow rate and ratio for the installed brix screw flow control.

⚠ ATTENTION

The direction to increase/decrease the flow rate for the new brix screw is the opposite of the valves existing syrup flow control. Turn the flow control counter-clockwise to increase the flow rate and clockwise to decrease the flow rate.

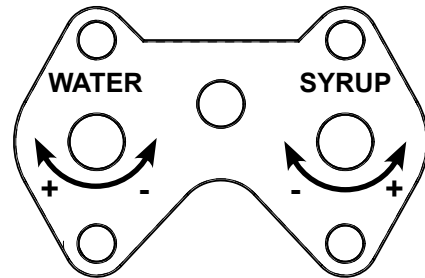

15. Once the syrup flow rate is set, re-install the valve cover and I.D. Panel.

Lancer Corp., 6655 Lancer Blvd., San Antonio, Texas 78219 - 800-729-1500 - Technical Support/Warranty: 800-729-1550

custserv@lancercorp.com - lancercorp.com - Manual PN: 28-3009 - May 2018

"Lancer" is the registered trademark of Lancer © 2018 by Lancer, all rights reserved.